

■ HYNC-SERIES(Single Blade)



■ Features:

- Compact design.
- Easy to use.
- Seven models of nut splitter to choose from.
- Unique angled head design for a variety of applications.
- Single action cylinder with hydraulic advance with spring-return.
- Operated by any hydraulic pump with rated oil pressure of 700 bar (10,000 psi).

■ Specifications:Single Blade Type

Model No.	Bolt Range	Hex Nut Range (mm)	Capacity (ton)	Oil Capacity (cm ³)	Dimensions (mm)			Net Weight (kg)	Gross Weight (kg)
					Length	Width	Height		
HYNC-1319	M6-M12	10-19	5	15	170	40	48	1.2	2.6
HYNC-1924	M12-M16	19-24	10	20	191	54	62	2.0	3.6
HYNC-2432	M16-M22	24-32	15	60	222	64	72	3.0	5.2
HYNC-3241	M22-M27	32-41	20	80	244	75	88	4.4	7.0
HYNC-4150	M27-M33	41-50	35	155	288	94	105	8.2	13.6
HYNC-5060	M33-M39	50-60	50	240	318	106	128	11.8	18.4
HYNC-6075	M39-M48	60-75	90	492	393	156	181	34.1	42.7

■ Dimensions:

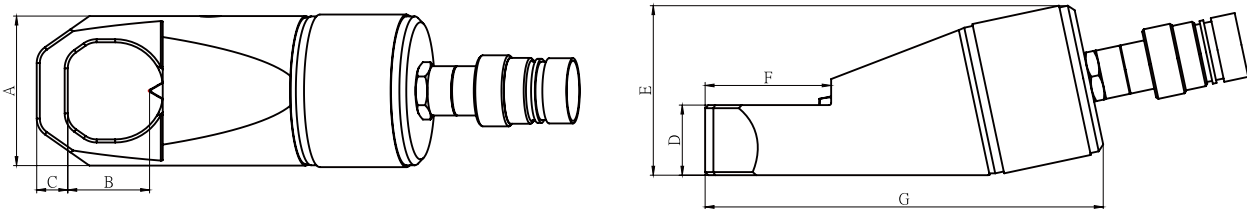

Unit: mm

Model No.	A	B	C	D	E	F	G	Spare Chisels No.	
HYNC-1319	40	21	7	19	50	29	120	HYNC-1319 #4	Chisel
HYNC-1924	54	25	10	25	62	40	146	HYNC-1924 #4	Chisel
HYNC-2432	64	33	13	30	76	52	180	HYNC-2432 #4	Chisel
HYNC-3241	70	42	16	36	87	65	205	HYNC-3241 #4	Chisel
HYNC-4150	90	52	21	45	108	76	245	HYNC-4150 #4	Chisel
HYNC-5060	106	60	24	54	125	92	288	HYNC-5060 #4	Chisel
HYNC-6075	156	80	27	75	184	110	365	HYNC-6075 #4	Chisel

- **Caution** : Only suitable for ≤ grade 8 nuts, splitting of stainless, square, and / or star nuts are prohibited. Nut hardness must not exceed HRC-44.

■ HYNC-SERIES(Double Blade)



■ Features:

- Compact design.
- Easy to use.
- Seven models of nut splitter to choose from.
- Unique angled head design for a variety of applications.
- Single action cylinder with hydraulic advance with spring-return.
- Operated by any hydraulic pump with rated oil pressure of 700 bar (10,000 psi).
- One extra blade to advance the cut.

■ Specifications:Double Blade

Model No.	Bolt Range	Hex Nut Range (mm)	Capacity (ton)	Oil Capacity (cm ³)	Dimensions (mm)			Net Weight (kg)	Gross Weight (kg)
					Length	Width	Height		
HYNC-1319D	M6-M12	10-19	5	15	223	44	67	1.3	2.8
HYNC-1924D	M12-M16	19-24	10	20	250	56	74	2.4	3.8
HYNC-2432D	M16-M22	24-32	15	60	275	64	78	3.5	5.4
HYNC-3241D	M22-M27	32-41	20	80	305	77	90	5.1	7.2
HYNC-4150D	M27-M33	41-50	35	155	344	97	111	9.7	13.8
HYNC-5060D	M33-M39	50-60	50	240	386	115	131	14.7	18.6
HYNC-6075D	M39-M48	60-75	90	492	476	170	186	40.7	42.9

■ Dimensions:

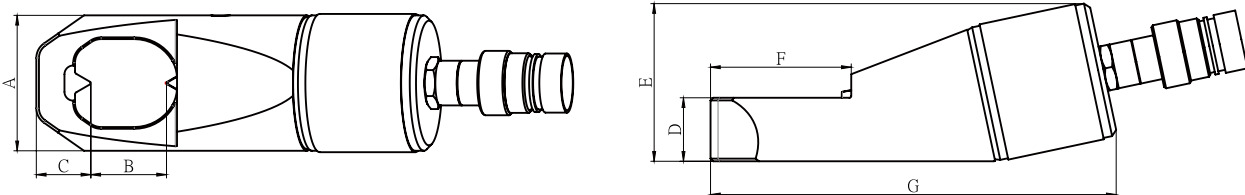

Unit: mm

Model No.	A	B	C	D	E	F	G	Spare Chisels No.	
HYNC-1319D	40	21	18	19	53	41	139	HYNC-1319D #7、#10	Chisel
HYNC-1924D	54	26	22	25	66	50	168	HYNC-1924D #7、#10	Chisel
HYNC-2432D	64	34	26	30	78	65	198	HYNC-2432D #7、#10	Chisel
HYNC-3241D	77	43	31	36	90	80	231	HYNC-3241D #7、#10	Chisel
HYNC-4150D	94	52	39	45	111	93	271	HYNC-4150D #7、#10	Chisel
HYNC-5060D	106	32	43	54	131	107	315	HYNC-5060D #7、#10	Chisel
HYNC-6075D	156	77	54	75	186	133	411	HYNC-6075D #7、#10	Chisel

■ **Caution** : Only suitable for ≤ grade 8 nuts, splitting of stainless, square, and / or star nuts are prohibited. Nut hardness must not exceed HRC-44.

NUT SPLITTER

■ Accessories

Model No.	Hex Wrench (mm)	Packaging
HYNC-1319	2.5 & 4	KuDos® Plastic Carrying Case
HYNC-1924	3 & 5	
HYNC-2432	4 & 6	
HYNC-3241	4 & 6	
HYNC-4150	4 & 6	
HYNC-5060	5 & 6	Crate
HYNC-6075	5 & 6	

Model No.	Hex Wrench (mm)	Packaging
HYNC-1319D	2.5 & 4	KuDos® Plastic Carrying Case
HYNC-1924D	3 & 5	
HYNC-2432D	4 & 6	
HYNC-3241D	4 & 6	
HYNC-4150D	4 & 6	
HYNC-5060D	5 & 6	Crate
HYNC-6075D	5 & 6	



■ Model No. PF-1319

Length : 333 mm

Weight : 2.1 kgs

■ Specifications:

Max. Pressure : 600 bar

Oil Required : 17 cc

Max. Output : 5.7 tons / 55.86 kN

Bolting Range : M6~M12
(Hex. Nut range : 10-19mm)

■ Bolting Capacity:

Jaw opening : 24.3 mm

Ram Stroke : 17.3 mm

■ Features:

- Light weight, compact and slim design.
- 180° degree rotating head for convenient operation.
- Single stage pumping .
- Relief valve.

■ Accessories:

Carrying Bag

■ Caution :

Only suitable for ≤ grade 8 nuts,
splitting of stainless, square, and / or
star nuts are prohibited.
Nut hardness must not exceed HRc-44.



Spare Chisel No.

PF-1319 #2

Chisel



NUT SPLITTER

■ Model No. **PF-2432**

Length : 562 mm

Weight : 6.9 kgs

■ Specifications:

Max. Pressure : 700 bar

Oil Required : 47.5 cc

Max. Output : 16.6 tons / 162.6 kN

Bolting Range : M16~M22

(Hex. Nut range : 24-32mm)

■ Bolting Capacity:

Jaw opening : 33 mm

Ram Stroke : 20 mm

■ Features:

- Light weight, compact and slim design.
- 180° degree rotating head for convenient operation.
- Single stage pumping .
- Relief valve.

■ Accessories:

Carrying Bag

■ Caution :

Only suitable for ≤ grade 8 nuts,
splitting of stainless, square, and / or
star nuts are prohibited.

Nut hardness must not exceed HRc-44.



Spare Chisel No.

PF-2432 #14

Chisel